





CONTACT US

 D-318, Neelkanth Business Park
Near Vidyavihar Bus Depot,
Ramdev Nagar, Vidyavihar (West),
Mumbai 400 086, Maharashtra, India.

 +91 - 22 - 2514 4129

 info@ecofootforward.com
enquiry@ecofootforward.com
career@ecofootforward.com

 www.ecofootforward.com

FOLLOW US

 facebook.com/ecofootforward

 linkedin.com/company/ecofootforward



QCI-NABET Accredited
under
Environmental Impact Assessment (EIA) Scheme
& Ground Water Consultant Accreditation (GWCO) scheme

ISO-9001:2015





Amey Gawade

Founder & Managing Director

NABET Accredited EIA Coordinator (EC) for 38 (Building & Construction projects), 39 (Township & Area development projects), 33 (Ports, harbours, break waters and dredging), 21 (Synthetic organic chemicals industry), 1 (a) Mining of minerals including opencast / underground mining & Functional Area Expert (FAE) for Water pollution monitoring, prevention and control (WP) & Municipal Solid Wastes (MSW).

He has completed his Master in Environmental Sciences and pursuing research in the field of Environment for Doctorate title. He possesses valuable experience of working with Environment Department, Maharashtra for the committee / authority (SEAC & SEIAA) formed under EIA notification, 2006. He has experience of scrutinizing various categories of proposals such as construction, mining, power plant, pharmaceutical, industrial projects etc.

Apart from his legal and technical experience in the Government, he is looking the environmental issue with different dimension and coming up with innovations. He has applied for a patent regarding e-waste and municipal waste management which can be applicable for district, city or township.

“ To bring every single individual on one common platform and form a responsible human chain to serve the direction to humankind to achieve the target of "Sustainable Development".



VISION

Provide direction to bring into reality "Sustainable Development".



MISSION

- ▶ To be leader in providing customer satisfaction through Quality and Service innovation in the field of Environment.
- ▶ Addressing various stake holders including the Government to achieve the goal of "Sustainable Development".
- ▶ Provide a platform to develop young Environmentalists.
- ▶ Design & Developing new techniques and methodologies.
- ▶ Environmental Awareness.



QUALITY POLICY

- ▶ Ecofootforward as an environmental consultant strives for the highest quality standards in providing services to achieve 'Sustainable Development' and keeps employees aware of the commitment.
- ▶ Ecofootforward complies with all statutory and other requirements and strives to continually improve the effectiveness of its Quality Management System.
- ▶ Ecofootforward aims to achieve total customer satisfaction through its established quality management system, including procedures for setting objectives along with a review mechanism.

DEPARTMENTS

Ecofootforward has established following departments based on its specialization:

EIA

Department of Environmental Impact Assessment

- ▶ Environmental Clearance
- ▶ Environment Impact Assessment (EIA) Study
- ▶ Environmental Management Plan (EMP)

CRZ

Department of Coastal Regulatory Zone

- ▶ Coastal Regulatory Zone (CRZ) Clearance
- ▶ CRZ Demarcation and Classification
- ▶ Mangrove Management Plan (MMP)

DD

Department of Due Diligence

- ▶ Environmental Site Assessment (ESA)
- ▶ IFC Performance Standards on Environmental and Social Sustainability
- ▶ Due Diligence

PPM

Department of Consent Management & Post Project Monitoring

- ▶ Consent to Establish & Operate from SPCB/CPCB
- ▶ Authorization from SPCB/CPCB
- ▶ Six monthly post project monitoring

EB

Department of Ecology & Biodiversity

- ▶ Forest & Wildlife Clearance
- ▶ Terrestrial & Marine surveys
- ▶ Biodiversity Impact Assessment
- ▶ Species specific conservation plans

LRC

Department of Lake & River Conservation

- ▶ DPR Preparation
- ▶ Conservation Plan
- ▶ Restoration and Beautification

SA

Department of Sustainable Architecture

- ▶ Green Building Certification
- ▶ Building Performance Study
- ▶ ECBC Compliance

GI

Department of Geo-Informatics

- ▶ CGWA NOC
- ▶ Comprehensive Hydrogeological Study / Impact Assessment Report
- ▶ GIS Based Study

LD

Department of Landscape Design

- ▶ 3D Walkthrough
- ▶ Plantation Planning and Designing
- ▶ Landscape Execution

TS

Department of Traffic Study

- ▶ Traffic Baseline Study
- ▶ Traffic Management Plan
- ▶ Traffic Impact Assessment

SS

Department of Social Science

- ▶ Social Impact Assessment
- ▶ Corporate Social Responsibility
- ▶ R&R Study

TA

Department of Training & Audit

- ▶ Professional Training
- ▶ Green Audit for the Educational Institute

Environmental Impact Assessment (EIA)

We provide pro-active consultation, advice, assistance, alternative technologies and end-of-pipe solutions to various types of industries, organizations & firms to meet their requirements:

- ▶ **Statutory Environmental Compliances**
 - Environmental Clearance (EC)
 - Coastal Regulatory Zone (CRZ) NOC
 - Forest & Wildlife Clearance
 - Consent to Establish (CTE), Operate (CTO) and Renewal
 - Six Monthly Post Project Monitoring
- ▶ **Baseline Environmental Studies**
- ▶ **Impact assessment & Mitigation measures**
- ▶ **Environment Management Plan (EMP)**
- ▶ **Species specific/ Wildlife Management & Conservation Plan (WMP)**
- ▶ **Mangrove Management Plan (MMP)**
- ▶ **Designing & execution of Corporate Environmental Responsibility (CER) & Corporate Social Responsibility (CSR)**

Construction and Township

If you are looking for single roof services for construction projects, townships, hospitals, malls, IT parks, logistics, commercial complexes, resorts then here is what we can offer you:

ASSISTANCE FOR OBTAINING THE LEGAL PERMISSION:

- ▶ Environmental Clearance (EC)
- ▶ Environment Impact Assessment (EIA) Study
- ▶ Forest & Wildlife Clearances
- ▶ Consent to Establish & Operate from State Pollution Control Board (SPCB)
- ▶ CGWA NOC for extraction of ground water from CGWA & CGWB
- ▶ Six Monthly Post Project Monitoring Compliances
- ▶ Coastal Regulatory Zone (CRZ) NOC from SCZMA
- ▶ Green Building Certification from GRIHA or LEED IGBC

APART FROM PERMISSION, WE ALSO ASSIST IN DESIGNING, EXECUTION O&M:

- ▶ Sustainable Architecture Planning & Recommendation to Design Architect as per the requirement of ECBC, GRIHA, or LEED IGBC
- ▶ Landscape design
- ▶ Solid waste facility management facilities
- ▶ Geo-hydrological Surveys
- ▶ Rainwater Harvesting
- ▶ Revamping or O&M of Sewage Treatment Plan & Water Treatment Plan (WTP)
- ▶ Designing & execution of Corporate Environmental Responsibility (CER) & Corporate Social Responsibility (CSR)
- ▶ Environmental Image Branding through various activities



Industry

We are QCI-NABET Accredited Consultancy for facilitating Environmental Clearance for various categories of industries listed under schedule of EIA notification.

ASSISTANCE FOR OBTAINING THE LEGAL PERMISSION:

- ▶ Environmental Clearance (EC)
- ▶ Environment Impact Assessment (EIA) Study
- ▶ Forest & Wildlife Clearances
- ▶ Consent to Establish & Operate from State Pollution Control Board (SPCB)
- ▶ CGWA NOC for extraction of ground water from CGWA & CGWB
- ▶ Six Monthly Post Project Monitoring Compliances
- ▶ Coastal Regulatory Zone (CRZ) NOC from SCZMA
- ▶ Green Building Certification from GRIHA or LEED IGBC

APART FROM PERMISSION, WE ALSO ASSIST IN DESIGNING, EXECUTION O&M:

- ▶ Sustainable Architecture Planning & Recommendation to Design Architect as per the requirement of ECBC, GRIHA, or LEED IGBC
- ▶ Landscape design
- ▶ Solid waste facility management facilities
- ▶ Geo-hydrological Surveys
- ▶ Rainwater Harvesting
- ▶ Revamping or O&M of Sewage Treatment Plan & Water Treatment Plan (WTP)
- ▶ Designing & execution of Corporate Environmental Responsibility (CER) & Corporate Social Responsibility (CSR)
- ▶ Environmental Image Branding through various activities



Mining

We are QCI-NABET Accredited Consultancy for facilitating Environmental clearance for the mining of minerals including opencast & underground mining.

ASSISTANCE FOR OBTAINING THE LEGAL PERMISSION:

- ▶ Environmental Clearance (EC)
- ▶ Environment Impact Assessment (EIA) Study
- ▶ Forest & Wildlife Clearances
- ▶ Consent to Establish & Operate from State Pollution Control Board (SPCB)
- ▶ CGWA NOC for extraction of ground water from CGWA & CGWB
- ▶ Six Monthly Post Project Monitoring Compliances
- ▶ Coastal Regulatory Zone (CRZ) NOC from SCZMA
- ▶ Green Building Certification from GRIHA or LEED IGBC

APART FROM PERMISSION, WE ALSO ASSIST IN DESIGNING, EXECUTION O&M:

- ▶ Sustainable Architecture Planning & Recommendation to Design Architect as per the requirement of ECBC, GRIHA, or LEED IGBC
- ▶ Landscape design
- ▶ Solid waste facility management facilities
- ▶ Geo-hydrological Surveys
- ▶ Rainwater Harvesting
- ▶ Revamping or O&M of Sewage Treatment Plan & Water Treatment Plan (WTP)
- ▶ Designing & execution of Corporate Environmental Responsibility (CER) & Corporate Social Responsibility (CSR)
- ▶ Environmental Image Branding through various activities



Data Centre / Information Technology

We provide specialists with experience and knowledge to provide guidance as per the requirement of Environmental Legislation in India as well as due diligence as per American Society for Testing and Materials (ASTM). If this is your requirement, then we can assure you of the following services.

DUE DILIGENCE:

- ▶ Environmental Site Assessment (ESA as per the ASTM)
- ▶ Flood Assessment
- ▶ Input for the Master Plan and Preliminary Engineering
- ▶ Environmental Testing
- ▶ Air Quality Test
- ▶ Ambient Noise Level Monitoring
- ▶ Site Reconnaissance and Subsurface Investigation

ASSISTANCE FOR OBTAINING THE LEGAL PERMISSION:

- ▶ Environmental Clearance (EC)
- ▶ Environment Impact Assessment (EIA) Study
- ▶ Forest & Wildlife Clearances
- ▶ Consent to Establish & Operate from State Pollution Control Board (SPCB)
- ▶ CGWA NOC for extraction of ground water from CGWA & CGWB
- ▶ Six Monthly Post Project Monitoring Compliances
- ▶ Coastal Regulatory Zone (CRZ) NOC from SCZMA
- ▶ Green Building Certification from GRIHA or LEED IGBC

APART FROM PERMISSION, WE ALSO ASSIST IN DESIGNING, EXECUTION O&M:

- ▶ Sustainable Architecture Planning & Recommendation to Design Architect as per the requirement of ECBC, GRIHA, or LEED IGBC
- ▶ Landscape design
- ▶ Solid waste facility management facilities
- ▶ Geo-hydrological Surveys
- ▶ Rainwater Harvesting
- ▶ Revamping or O&M of Sewage Treatment Plan & Water Treatment Plan (WTP)
- ▶ Designing & execution of Corporate Environmental Responsibility (CER) & Corporate Social Responsibility (CSR)
- ▶ Environmental Image Branding through various activities

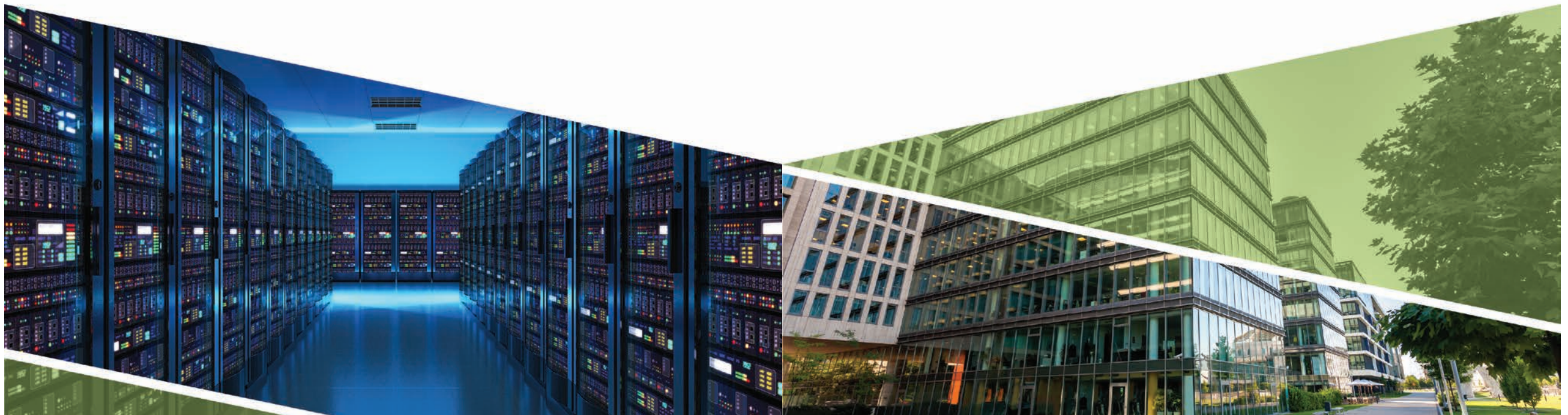

Ports, Harbours and Jetties

We are a QCI-NABET Accredited Consultancy for facilitating EC for ports, harbours, break waters and dredging.

ASSISTANCE FOR OBTAINING THE LEGAL PERMISSION:

- ▶ Environmental Clearance (EC)
- ▶ Environment Impact Assessment (EIA) Study
- ▶ Forest & Wildlife Clearances
- ▶ Consent to Establish & Operate from State Pollution Control Board (SPCB)
- ▶ CGWA NOC for extraction of ground water from CGWA & CGWB
- ▶ Six Monthly Post Project Monitoring Compliances
- ▶ Coastal Regulatory Zone (CRZ) NOC from SCZMA
- ▶ Green Building Certification from GRIHA or LEED IGBC

APART FROM PERMISSION, WE ALSO ASSIST IN DESIGNING, EXECUTION O&M:

- ▶ Sustainable Architecture Planning & Recommendation to Design Architect as per the requirement of ECBC, GRIHA, or LEED IGBC
- ▶ Landscape design
- ▶ Solid waste facility management facilities
- ▶ Geo-hydrological Surveys
- ▶ Rainwater Harvesting
- ▶ Revamping or O&M of Sewage Treatment Plan & Water Treatment Plan (WTP)
- ▶ Designing & execution of Corporate Environmental Responsibility (CER) & Corporate Social Responsibility (CSR)
- ▶ Environmental Image Branding through various activities



Due Diligence

EcoFootForward has the most experienced specialists with in-depth knowledge to inform and guide your projects to comply with all requirements of Environmental Legislation in India as well as ASTM.

- ▶ Conducting due diligence study for the selection and finalizing of the property as per American Society for Testing & Materials (ASTM) Standards, to check for environmental contamination of site under consideration, potential financial and commercial implications along with EHS and any other liabilities associated with the project and business proposition.
- ▶ Assistance to obtain all the relevant environmental permissions with regular renewal of approvals from the competent authorities.

DUE DILIGENCE:

- ▶ Environmental Assessment (ESA as per the ASTM).
 - **ESA Phase I:** To identify the potential or existing environmental contamination and other linked liabilities of the project.
 - **ESA Phase II:** Testing the quality and establishing values of the various contaminants by sampling soil, groundwater and or building materials.
 - **ESA Phase III:** Delineating the physical extent of contamination based on recommendations made in Phase II assessments and study of alternative clean-up methods and logistics.
- ▶ Flood risk and flood plain assessment
- ▶ Inputs for the masterplans and preliminary engineering
- ▶ Environmental Testing
- ▶ Air Quality Testing
- ▶ Ambient Noise Level monitoring
- ▶ Site reconnaissance and subsurface investigation



Consent Management & Post-Project Monitoring

EcoFootForward's Department of Consent Management & Post-Project Monitoring, offers the following project related services:

- ▶ Consent management services to all industries under the categories prescribed by the Central Pollution Control Board & State Pollution Control Board. Consent management services include Consent to Establish, Operate & authorization.
- ▶ Six monthly post project monitoring compliance report submissions to Regional Offices of the Ministry of Environment and Forests & Climate Change.

Coastal Regulation Zones

EcoFootForward offers various services to obtain CRZ related clearances under CRZ Notification, 2011/2019 & subsequent amendments, for all types of developments being done within this highly sensitive coastal zone.

ALLIED SERVICES FOR CRZ NOC:

- ▶ Assisting designers, architects & infrastructure consultants with the design process for projects within the CRZ area.
- ▶ Baseline Environmental Studies.
- ▶ Impact assessment & mitigation measures
- ▶ Environment Management Plan (EMP)
- ▶ Species specific / wildlife management and conservation plan
- ▶ Mangrove Management Plan (MMP)
- ▶ Flamingo Marine National Park NOC
- ▶ National Park NOC
- ▶ Forest and Wildlife NOC
- ▶ Fish and Fisheries NOC



Ecology & Biodiversity

EcoFootForward's team of specialists provides research based solutions. We have the best high-end infrastructure and relevant expertise from multiple streams all under one roof to provide the most viable solutions to our clients. We offer the following customized consultancy services for the terrestrial and marine environment.

PERMISSIONS FROM COMPETENT BODY:

- ▶ Forest and Wildlife Clearance.

BIODIVERSITY CONSERVATION FOR TERRESTRIAL AND MARINE ENVIRONMENT:

- ▶ Biodiversity Survey and Assessment.
- ▶ Biodiversity Action and Management Plan.
- ▶ Local Biodiversity Strategy and Action Plan.
- ▶ Biodiversity inclusive Impact Assessment.
- ▶ Biodiversity Offsets and Habitat Creation.
- ▶ Habitat Mapping and Management.
- ▶ Mangrove Assessment and Conservation.
- ▶ Tree Census / Inventory.

- ▶ Tree Plantation.
- ▶ City / District Biodiversity Index.
- ▶ REDD+ Projects.
- ▶ Mine Restoration.
- ▶ Environmental Audit of Villages.
- ▶ Eco-village Design and Development.
- ▶ Human - Wildlife Conflict Assessment.
- ▶ Biodiversity Conservation Projects.
- ▶ Capacity Building and Workshops.
- ▶ Biodiversity Parks (Concept, Design, Implementation and Execution).

BUSINESS AND BIODIVERSITY:

- ▶ Natural Capital Assessment and Environmental Economics.
- ▶ Natural Value Initiative.



Lake and River Conservation

EcoFootForward's Department of Lake & River Conservation offers various customized consultancy services for advisory, planning, designing, implementation & monitoring purposes.

- ▶ Conservation of lake & river as an ecosystem.
- ▶ Eco-restoration of lakes & rivers including water quality improvement.
- ▶ Community participation for lake & river conservation.
- ▶ Conservational economy through educational tours and river and lake tourism (Eco-tourism)

WE ALSO OFFER FOLLOWING SERVICES UNDER STATE AND NATIONAL LAKE & RIVER CONSERVATION PROGRAMME:

- ▶ Pe-feasibility Report (PFR).
- ▶ Detailed Project Report (DPR).
- ▶ Compliance Monitoring in Execution Phase.



Landscape Design

We provide detailed scientific research-based solutions for landscape design services, using high-end infrastructure and expertise to provide enhanced solutions to all clients, ranging from Planning, Designing, Execution to Operation & Maintenance. Various specializations are provided from a multi-faceted team.

OBJECTIVES:

- ▶ Customized theme and design for both hardscape & softscape.
- ▶ Conservation of native biological diversity.
- ▶ Solutions to support all the linked ecosystems in the surrounding habitat.
- ▶ Minimizing of maintenance costs for the project.
- ▶ Conservation strategies during utilization of natural resources.



Geo-Informatics

EcoFootForward's Department of Geo-informatics offers the following services:



- Spatial data creation.
- Topographical Mapping.
- Parcel mapping.
- GIS Data Capture.
- Topographical mapping.
- Viewshed Analysis.
- Slope Analysis.
- Contour mapping.
- Proximity Analysis.
- High-resolution change detection analysis.
- Land Use Land Cover Analysis.
- Flood Risk Assessment.
- Central Ground Water Authority (CGWA) NOC.

Central Ground Water Authority (CGWA) NOC

EcoFootForward provides consultancy services for obtaining the permissions from Central Ground Water Authority (CGWA) for extraction of ground water for proposed or existing townships, commercial buildings, residential buildings and industries & covers the following scope:

- Geo-hydrological study to understand ground water conditions.
- Designing the Rainwater Harvesting (RWH) system.
- Consultancy to get the CGWA NOC & renewal time to time.
- Consultancy for the compliance filling of CGWA NOC.
- Execution of compliance as per the requirement of the clients.



Sustainable Architecture

EcoFootForward's Department of Sustainable Architecture and design offers a range of design and analyses that applies to all types of building projects spanning residential, commercial, educational, industry, masterplan, and township developments:

- ▶ High Performance Building Design Advisory services.
- ▶ Passive Solar Site Analysis and Space-use Planning.
- ▶ Building Energy Modelling.
- ▶ Daylight Analysis.
- ▶ Shadow Analysis and Facade Design.
- ▶ Wind and External CFD.
- ▶ Natural Ventilation.
- ▶ Detailed HVAC Internal CFD.
- ▶ Basement Ventilation CFD.
- ▶ Energy Consumption Pattern Analysis.
- ▶ Renewable Energy and Solar Photovoltaic.
- ▶ Urban Heat Island (UHI) Effect.
- ▶ Life Cycle Assessment (LCA).
- ▶ Ecological and Carbon Footprint.
- ▶ Green Building Certification:
 - GRIHA Rating System.
 - LEED – IGBC Compliance.
 - LEED – USGBC Compliance.
 - BREEAM Compliance- UK

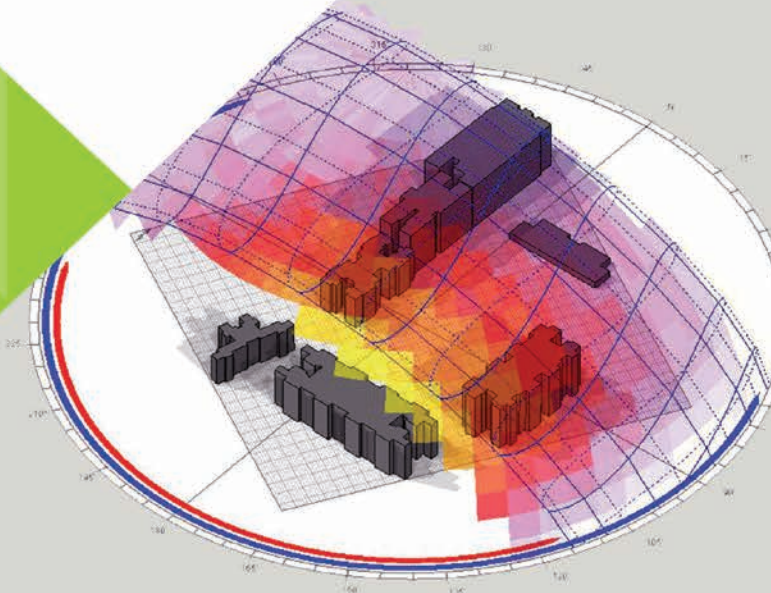

Traffic Studies

EcoFootForward offers highly accurate and error free traffic studies and analysis in the following areas.



- ▶ Traffic Data Collection up to 24 hrs.
- ▶ Cross-sectional analysis for divided and undivided roads and highways.
- ▶ Analysis of flow, density, capacity and LoS (Level of Service).
- ▶ Traffic density forecasting for 5 years, 10 years and 15 years.
- ▶ Swept Path analysis for emergency vehicular movement.
- ▶ Retrieval analysis of all personnel and vehicles on site for emergency evacuation.
- ▶ Traffic Impact Assessment.
- ▶ Traffic Management Plan.

Social Science

EcoFootForward offers the following specialized services under the fully developed department of Social Sciences:

- ▶ Social Study Surveys.
- ▶ Social Impact Assessment (SIA).
- ▶ Corporate Social Responsibility (CSR).
- ▶ Corporate Environmental Responsibility (CER).

CSR & CER Strategy

EcoFootForward offer service to develop the strategies and action plan for Corporate Social Responsibility (CSR) and Corporate Environmental Responsibility (CER) for Environmental Attributes. We also offer the services for implementation of the same including provision of digital platform to monitor the same and providing the performance evaluation report time to time.

WHY US?

EcoFootForward offers all the services in a diverse field of environment analysis and has a highly specialised team of Environmental Experts ensuring that every project achieves the desired results in a scientific manner. We ensure that you get the Highest Quality work in the best Value for Money while working with us.



Training & Audit

TRAINING

We provide all ISO standards / OSHAS training & specialised professional trainings specific to the Environment Sector from experienced and qualified professionals, for students, professionals, institutes and organizations. We also organize on-demand onsite training to suit all the client needs. The trainings are conducted in a comfortable and sanitized work environment.

AUDIT

We conduct the ISO Audits & Green Audit as per applicable standards from experienced qualified professionals for institutes and organizations.

Green Audit for Educational Institutions

EcoFootForward conducts Green Audits for Educational Institutions which includes the following:

- ▶ Action Plan formulation for implementation of Green policy for Institutions.
- ▶ Guidance on compliance of the reports as per NAAC policy.
- ▶ Site Visit and Audit as per NAAC policy.
- ▶ Providing assistance as a complete package to achieve the desired milestones during implementation of policy.
- ▶ Training of staff for implementation of policy and designing 'Initiatives Action Plan' and 'Action Evaluation Reports' as a part of Green Audit annual activity.



Clientele

RESIDENTIAL & COMMERCIAL COMPLEX

- ▶ Essel Group
- ▶ Mahindra Lifespaces
- ▶ Lotus Group
- ▶ Rohan Builders (India)
- ▶ Lakdawala Realty
- ▶ Hiranandani Group
- ▶ Vasocn Engineers
- ▶ Rajlaxmi Developers
- ▶ Dimple Enterprises
- ▶ Shree Ganesh Construction
- ▶ Mahindra Happinest
- ▶ Manisha Enterprises
- ▶ Clover Buildcorp
- ▶ Bharat Agri Fert & Realty
- ▶ Posco Maharashtra Steel

SLUM REHABILITATION PROJECTS

- ▶ TATA Power Company
- ▶ Great Saturn Infrastructure
- ▶ Parinee Group
- ▶ Jyoti Home Makers

IT PARK / IT PRODUCT MANUFACTURING

- ▶ SIFY Technologies
- ▶ CtrlS Datacenters
- ▶ Wipro
- ▶ Capgemini India
- ▶ TRIL IT4
- ▶ Rupa Infotech & Infrastructure
- ▶ Bridge Data Centre LLP
- ▶ Larsen & Toubro
- ▶ Shogini Technoarts

REDEVELOPMENT PROJECTS

- ▶ Metropolitan Properties
- ▶ Darvesh Properties

TOWNSHIP

- ▶ Riverview City Constructions
- ▶ Essel Group
- ▶ Ramnath Group
- ▶ Nanded City Development & Construction
- ▶ Sabio Eagle Realtors
- ▶ Empire Industries
- ▶ Magarpatta City Development Company
- ▶ Harihar Infrastructure Development Corp

HILL STATION

- ▶ Aqualand (India)

CONSTRUCTION PROJECT/ GOVERNMENT

- ▶ PWD

FOOD INDUSTRY

- ▶ Nilon's Enterprises

CIGARETTE INDUSTRY

- ▶ Godfrey Phillips India

RESORT

- ▶ Mahindra Holidays and Resorts India
- ▶ The Resort (K Raheja Group)
- ▶ Anchaviyo Resort

INDUSTRIAL GALLS / SHED

- ▶ Indospace Group
- ▶ ESR Pune Industrial Park
- ▶ Welspun Group
- ▶ Empire Industries
- ▶ Gami Group

PAINT INDUSTRY

- ▶ Berger Paints India
- ▶ BSN Paints India

PACKAGING INDUSTRY

- ▶ A. I. Packaging (Ajanta Pharma)

EDUCATIONAL INSTITUTE

- ▶ D.Y. Patil Institute of Engineering & Technology, Pimpri-Haveli, Pune
- ▶ D.Y. Patil Medical College Hospital & Research Center, Pimpri Pune

LAKE CONSERVATION

- ▶ Shrigonda Municipal Council, Ahmednagar
- ▶ Ashtha Municipal Council, Ashtha, Sangli
- ▶ Buldana Municipal Council, Buldana
- ▶ Nagothane Gram Panchayat, Nagothane
- ▶ Barshi Municipal Council, Barshi, Solapur

AUTOMOTIVE INDUSTRY

- ▶ Mahindra & Mahindra (Automotive Division)
- ▶ Mahindra & Mahindra (Farm Division)

HIGHWAY & ROADS

- ▶ Maharashtra Rural Roads Development Association (M.R.R.D.A.)

BANK

- ▶ Kotak Mahindra Bank

PHARMA INDUSTRY

- ▶ Cogent Life Sciences
- ▶ Harishree Aromatic & Chemicals
- ▶ Kimiya Biopharm Innovations

METAL / STEEL INDUSTRY

- ▶ JSW Coated Steel Products
- ▶ Aqua Alloys

JETTY / PORTS / MARINE STUDY

- ▶ Panduranga Timblo Group
- ▶ Yogayatana Ports
- ▶ Rock & Reef
- ▶ Maharashtra Maritime Board
- ▶ CSIR-National Institute of Oceanography, Goa

COMMON EFFLUENT TREATMENT PLANT

- ▶ Badlapur CETP Association, Badlapur

HOSPITALS

- ▶ Tata Memorial Centre, Kharghar
- ▶ Tata Memorial Centre, Lower Parel
- ▶ MNR Healthcare, Navi Mumbai

POWER

- ▶ Ratnagiri Gas & Power

